



nox-crete®

chemical solutions to concrete problems

**KEEP THE SLAB HOLE-FREE  
AND KEEP THE JOB GOING!**

**CONSTRUCTION ADHESIVE & SEALANT**

**Nox-Grip** 

- FAST CURING
- PERFORMS WELL OVER A WIDE TEMPERATURE RANGE
- EXCEPTIONAL ADHESIVE STRENGTH
- COMPATIBLE WITH SILCOSEAL CURE AND BONDBREAKER

Nox-Grip is a premium-grade high strength, fast-setting structural polymer adhesive specifically formulated to securely attach PVC and wood reveals/rustication strips, chamfer and edge form brackets to concrete casting slab surfaces in tilt-up applications.

MADE IN THE  
**USA**  
Since 1956



[www.nox-crete.com](http://www.nox-crete.com)

# HOW IT WORKS

Nox-Grip is non-staining and provides excellent adhesion to green or damp concrete in all climates. As a sealant adhesive, Nox-Grip allows for the expansion and contraction experienced in the early stages of the concrete curing process while providing resistance to impact and vibration forces. With an initial set time of two hours and full cure in 24 hours, Nox-Grip provides a quick and efficient means for securely attaching a wide variety of items under multiple conditions to tilt-up casting surfaces.

**IDEAL FOR USE WITH CLEAN LINE REVEAL®  
OR ANY OTHER PLASTIC POLYMER OR  
WOOD TYPE RUSTICATION OR CHAMFER**



**CLEAN AREA WITH  
NOX-CRETE'S NOX-SOLV  
CLEANING SOLVENT**



**APPLY TWO  
PARALLEL BEADS  
ON REVEALS**



**APPLY REVEAL  
PRESS DOWN  
FIRMLY**



**An Easy 3-Step Application Process!**

## IDEAL FOR ATTACHING EDGE FORM BRACKETS

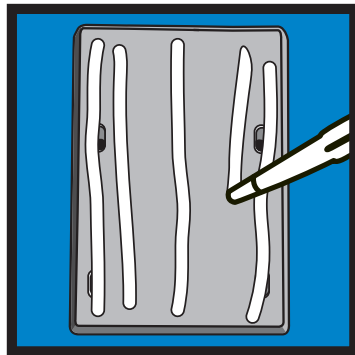
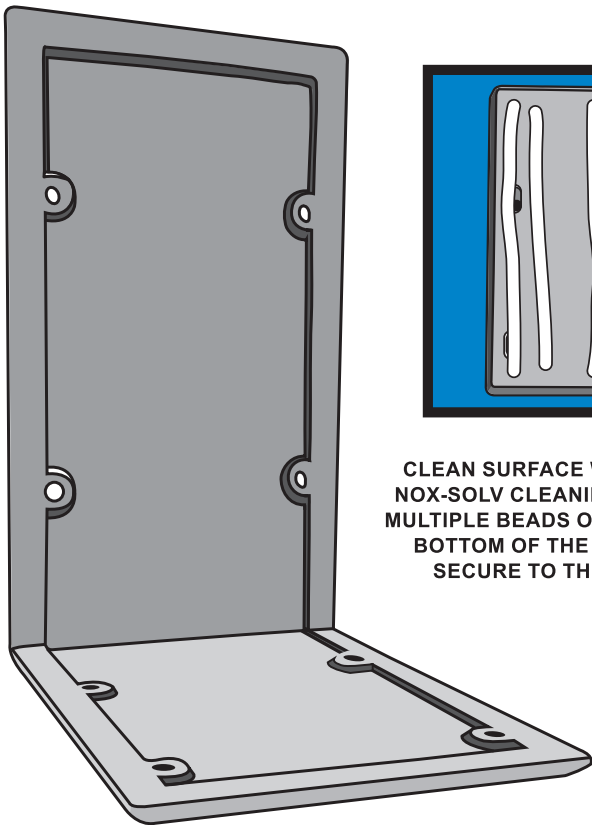

**CLEAN SURFACE WITH NOX-CRETE'S  
NOX-SOLV CLEANING SOLVENT. APPLY  
MULTIPLE BEADS ON EACH SIDE OF THE  
BOTTOM OF THE EDGE BRACKETS,  
SECURE TO THE CASTING SLAB.**

LEARN MORE



## ADVANTAGES

- Less Waste
- Non-Staining
- Easily Removable
- Reduces Labor Costs
- Fast Setting - 2 Hr. Initial Set Time
- Eliminates Floor Surface Damage
- Replaces Nails and Pinch Line
- Can be used to Attach Wood or PVC to Casting Slab Surfaces
- Effective at wide surface temperature range of 0° to 140° F (-17° to 60°C)
- Dependable Adhesion
- Predictable Coverage Rate versus Spray Adhesive
- Designed for use with Nox-Crete Clean Line Reveal® and Silcoseal® Bondbreakers
- Firmly Attaches Edge Form Brackets
- Easily removed from casting slab surfaces with razor blade scrapers once panels have been erected
- Meets all current federal and state VOC requirements throughout the US and Canada